

u

T  
of  
96  
he  
M  
sh

Th  
bel  
has

WI  
con  
of t

WE  
that  
in th  
the d

WH  
pern

NOW

"Porti

unclas

highly

vehicu

accom

design

improv

Title

Ancho

engine

investi

This d

subseq

be sub

This d

this do

not in

prior v

This I

Munic

**UNIVE**

**A Publi**

By: \_\_\_\_\_

Chris

STATE OF ALASKA  
THIRD JUDICIAL DIS

The foregoing instrume  
by Chris Turletes, in the

STATE OF ALA  
NOTARY PUBL  
C. J. Warmoth  
My Commission Expre

Reference Building Per:

RETURN RECORDED  
TO: Municipality of An  
Development Services I  
Community Developme  
P.O. Box 196650  
Anchorage AK 99519-6

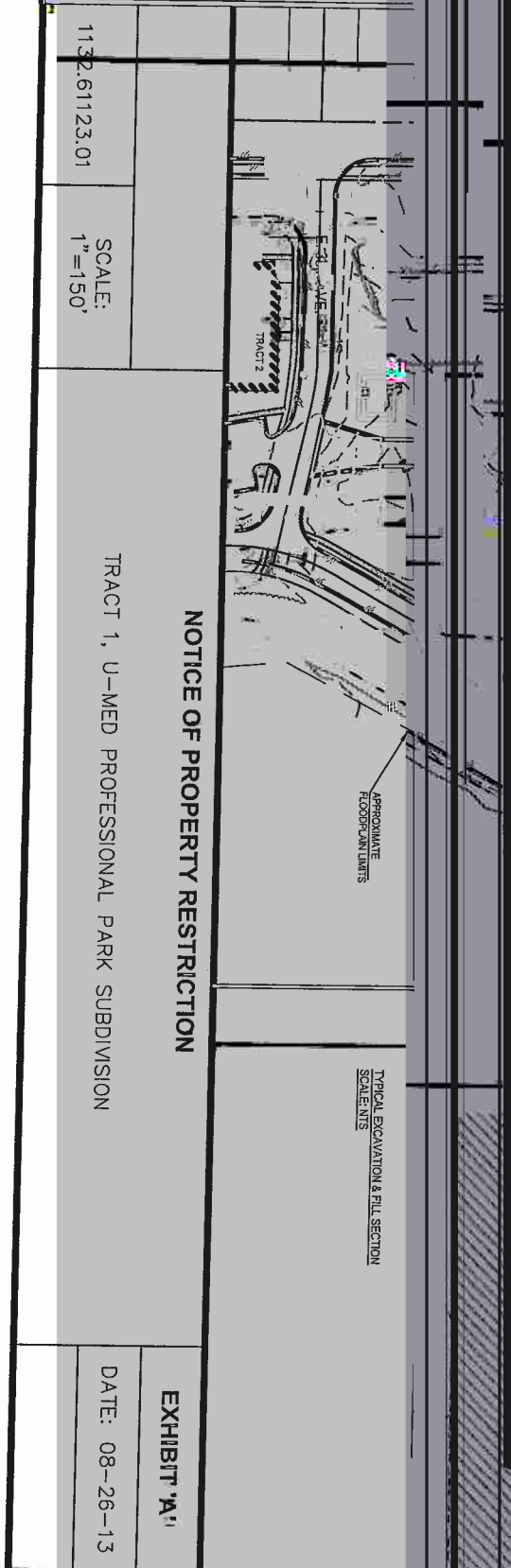

APPROXIMATE  
FLOODPLAIN LIMITS

TYPICAL EXCAVATION & FILL SECTION  
SCALE: NTS

**NOTICE OF PROPERTY RESTRICTION**

TRACT 1, U-MED PROFESSIONAL PARK SUBDIVISION

1132.61123.01

SCALE:  
1" = 150'

EXHIBIT 'A'

DATE: 08-26-13